

HEIGHT GAUGE

Especially developed and optimized for use in production lines, HI_CAL offers a great efficiency thanks to its large screen which can simultaneously display diameters and centrelines.

Its principal advantages consist in its ease of use, reduced dimensions of its base, its great lightness, the compatibility of the accessories with the instruments of the previous generation and the two travel speeds which offer a great comfort during the measurement of small diameters.

Inductive Sylvac system (patented)

Automatic motorized probe (patented)

Data output RS232 – USB

mm/inch conversion



Height gauge

Hi_Cal

DESCRIPTION

- Intuitive functions
- Great mobility
- Measurement of internal and external diameters, centerlines, heights, thicknesses, depths, surfaces
- Versions 150 and 300 mm
- Data output USB and RS232
- Measuring force extremely low and adjustable according to the probe
- No influence of the operator on the measurement result
- Battery life: 40 hours
- Probe constant value memorized even when switched off
- Continually adjustable probe speed



Height gauge

Hi_Cal

DIMENSIONAL DRAWINGS

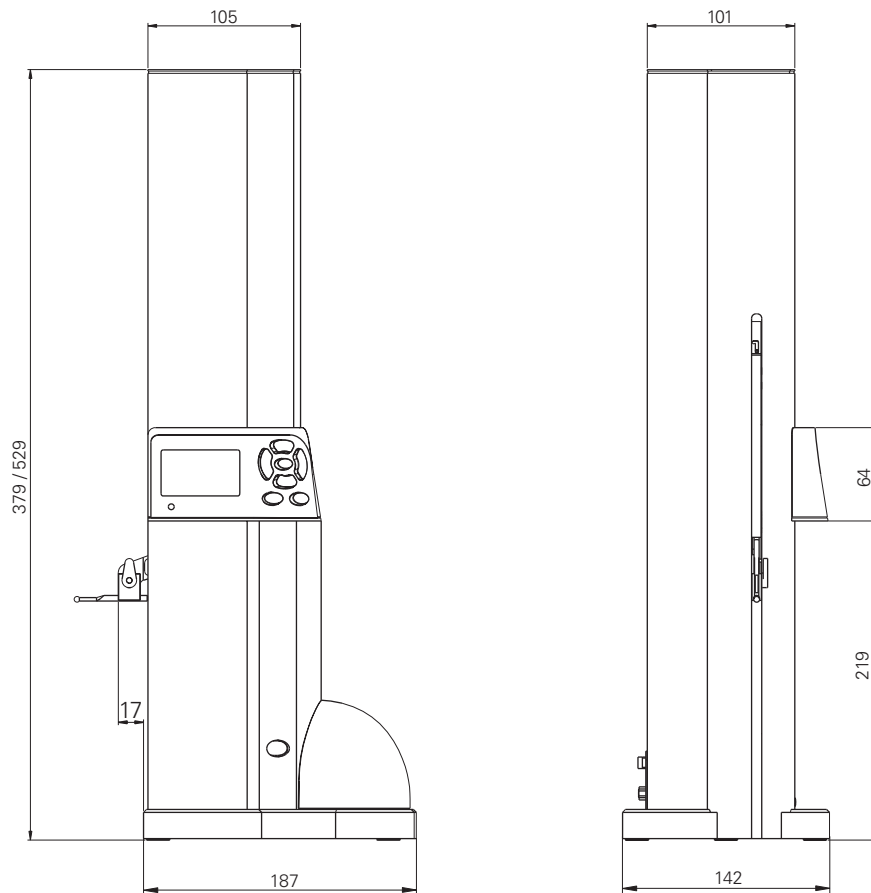

DISPLAYS

- 1 Measuring unit and actives reference
- 2 Display of measuring value
- 3 Active measuring mode
- 4 Centerline display
- 5 Dynamic measuring mode
- 6 Diameter / height measurement
- 7 Access to setting menu
- 8 Selection of reference Ref I / Ref II
- 9 ON / OFF Switch
- 10 Ball probe constant
- 11 Validation / Initialization of min, max mode
- 12 Luminous indication of valide measurement



TECHNICAL SPECIFICATIONS

		830.0150	830.0300
Measuring range	mm	150	300
Application range	mm	0 - 155	0 - 320
Max. Error	µm	2.5 + L / 175 ¹⁾	
Repeatability	µm	2	
Resolution	mm	0.01 / 0.001	
Velocity	mm/s	50 / 100	
Measuring force	N	0.2 - 0.3	
Self-contained use	h	> 40	
Height	mm	379	529
Weight	kg	3.9	4.6
S_Connect		USB / mini USB / RS232 ²⁾	
Programmable by PC		●	
Zero setting		●	
Min / max / delta		●	
PRESET function		●	
2 references		●	
Height measurement, Ø and centerlines		●	
2 types of progressive speed		●	

¹⁾ With standard probe, in laboratory conditions

²⁾ see cables chapter

BASIC INSTRUMENT

- Loose cover HI_CAL 150
- Loose cover HI_CAL 300
- Charging set (930.4010¹⁾/11/12/13)
- Ruby ball probe Ø 3 mm
- Setting gauge
- Calibration certificate

¹⁾ according to country

Height gauge

Hi_Cal

APPLICATIONS

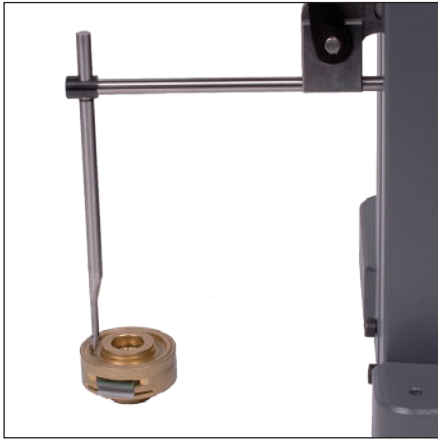

Depth measurements with accessories 930.2108 and 930.2105



Depth measurements with accessories 930.2108 and 905.2204



Internal measurements with ruby ball probe \varnothing 3 mm, 930.2101 (standard)



Internal groove measurements with accessories 930.2108, 930.2110 and 905.2207



Heights and thicknesses measurements with the standard probe 930.2101

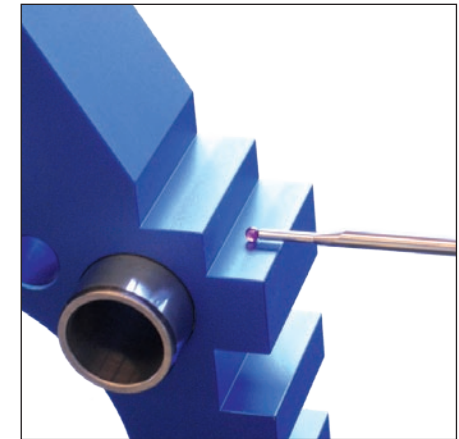

Taking the probe constant value with the setting bloc 930.2002 (standard)

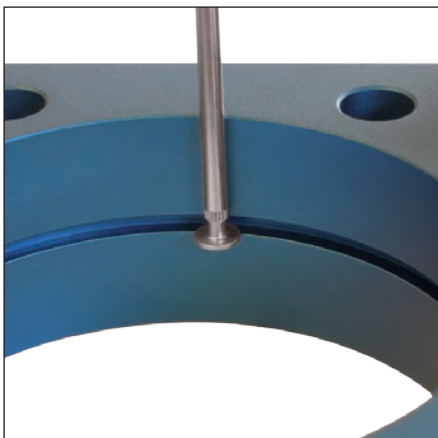

Internal groove measurements with accessories 930.2108, 930.2110 and 905.2205

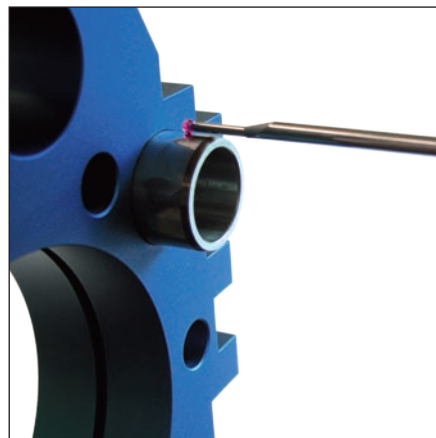

External diameter measurements with the standard probe 930.2101

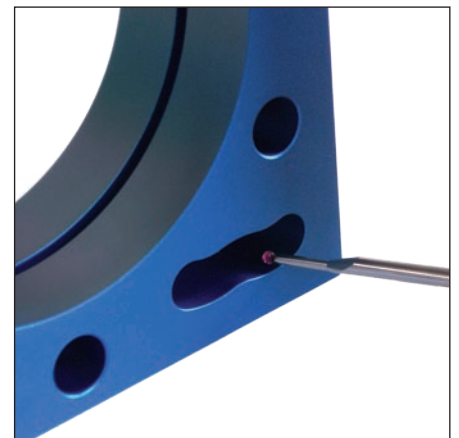

Min/Max/Delta measurements

ACCESSORIES

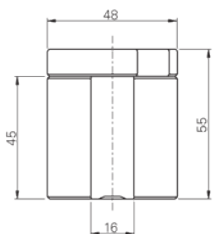
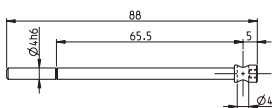
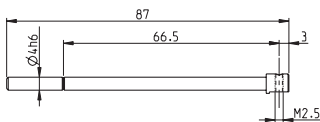
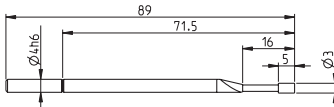
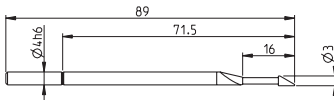
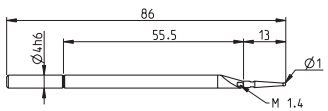
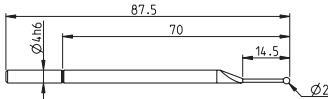
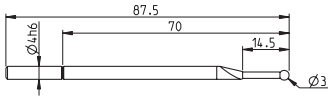

930.2101	Ruby ball probe Ø 3 mm
930.2103	Ruby ball probe Ø 2 mm
930.2104	Tungsten carbide ball probe Ø 1 mm
930.2105	Knife-edged measuring probe TC Ø 3 mm
930.2106	Cylindrical measuring probe TC Ø 3 mm
930.2107	Probe holder 90° M2.5
930.2108	Probe holder 90° Ø 4 mm
930.2002	Setting gauge
904.4010	Charging set 230V EUR
904.4011	Charging set 230V UK
904.4012	Charging set 120V US
904.4013	Charging set 100V JPN

Height gauge

Hi_Cal

ACCESSORIES

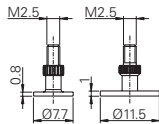
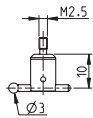
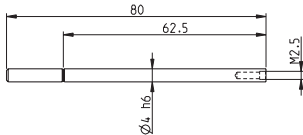
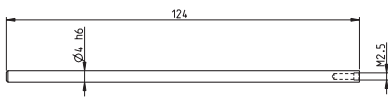
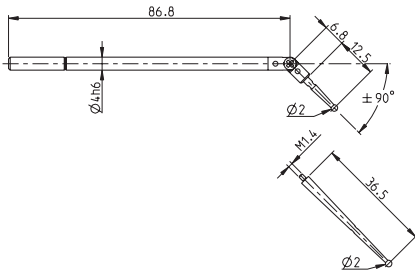

930.2102	Swivelling tungsten carbide ball probe (M1.4)
930.2109	Extension 124 mm M2.5
930.2110	Extension 80 mm M2.5
905.2207	Probe holder and ruby ball probe Ø 3 mm, M2.5
905.2205	Disk shaped anvils Ø 7.7 mm and Ø 11.5 mm, M2.5
930.2150	Full accessories set in wooden box Content : 930.2103, 930.2104, 930.2105, 930.2106, 930.2107, 930.2108, 930.2109, 930.2110, 905.2204, 905.2205, 905.2207
930.2151	Basic accessories set in wooden box Content : 930.2103, 930.2104, 930.2105, 930.2106
904.4101	External contact (foot-pedal)

